

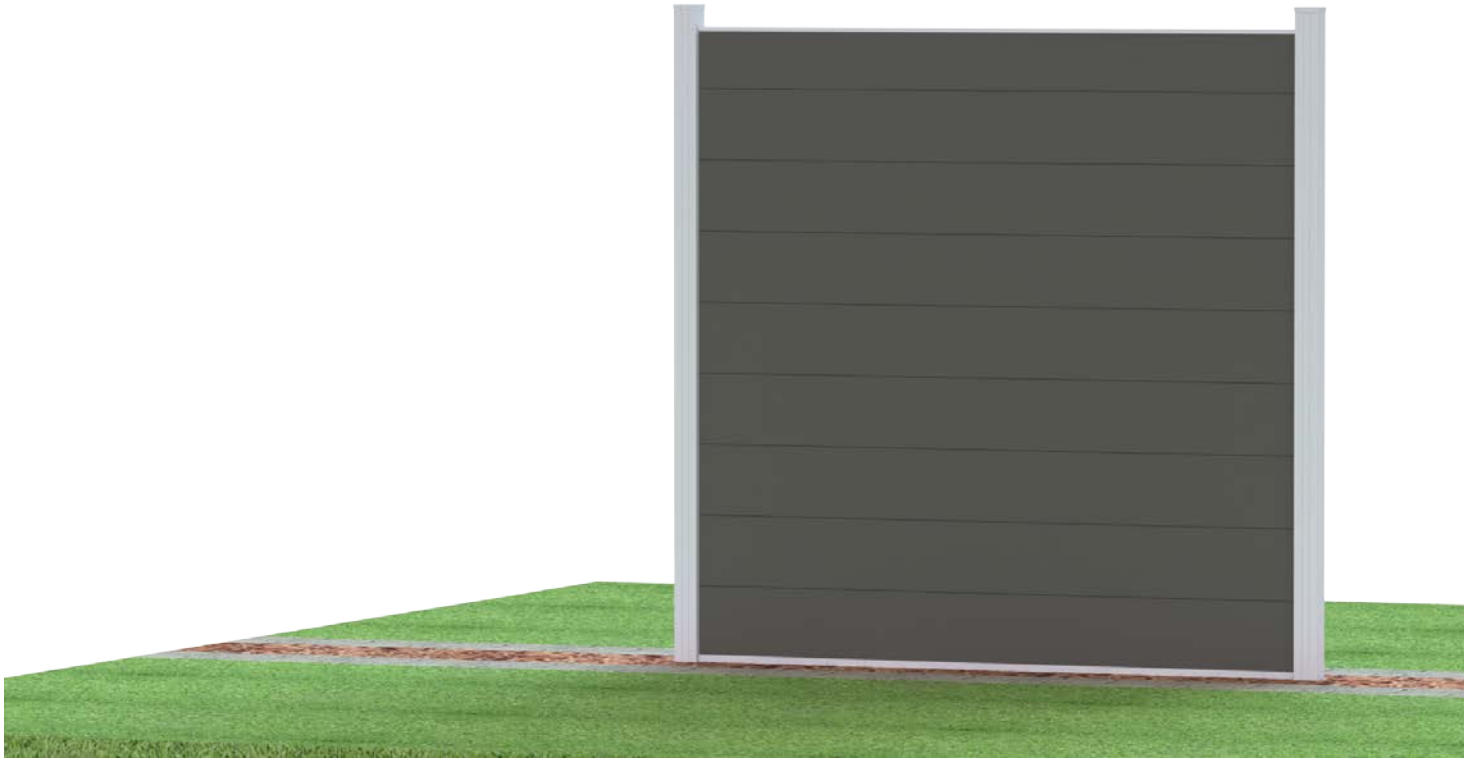

SUPERIOR
RANGE



For Installation Help or Information Contact Us At:

TOOLS REQUIRED FOR INSTALLATION



PARTS LIST

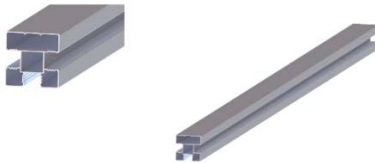

PART NO. 1: ALUMINUM POST
QTY: 1 + 1 END POST

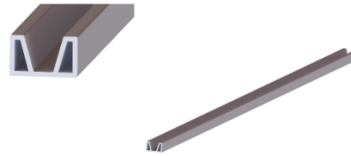

PART NO. 2: ALUMINUM TOP RAIL
QTY: 1



PART NO. 3: WPC PANEL
QTY: 9

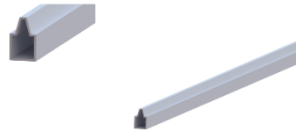

PART NO. 4: ALUMINUM BOTTOM RAIL
QTY: 1



PART NO. 5: ALUMINUM SPACER
QTY: 2

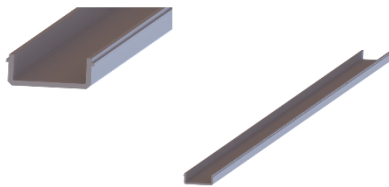

PART NO. 6: ALUMINUM COVER STRIP
(PACKAGED AS A PAIR, OPTIONAL ITEM)



PART NO. 7: POST CAP
QTY: 2

For Installation Help or Information Contact Us At:

www.ecompositeproducts.co.uk info@ecompositeproducts.co.uk 0800 599 9667

STEP 1: ALUMINUM POST INSTALLATION

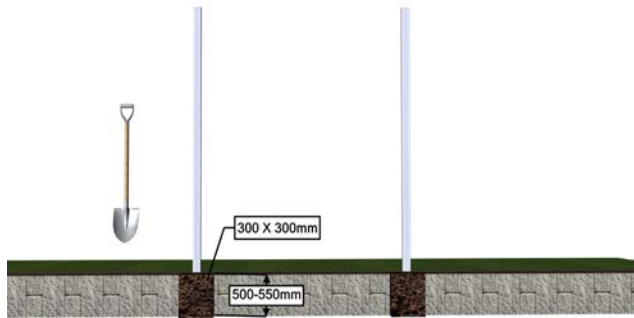

BEGIN THE INSTALLATION BY PLACING TWO ALUMINUM POSTS, PART ONE, AT A DISTANCE OF 1868 MILLIMETERS FROM CENTER TO CENTER.

NEXT, MARK THE LOCATION AND USE A SHOVEL TO DIG TWO 300 BY 300 BY 500 MILLIMETER DEEP HOLES. INSERT BOTH ALUMINUM POSTS INTO THE 500 MILLIMETER DEEP HOLES AND MAKE SURE BOTH POSTS STAND 1900 MILLIMETERS ABOVE GROUND LEVEL.

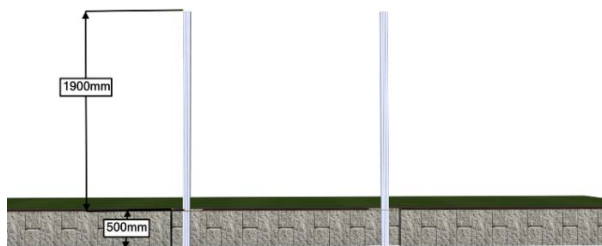

START TO FILL THE HOLES WITH CONCRETE AND USE A SPIRIT LEVEL TO ENSURE THE POSTS ARE LEVEL FRONT AND SIDE. MAKE SURE BOTH POSTS REMAIN STRAIGHT AND PARALLEL TO ONE ANOTHER.

STEP 2: INSTALLATION OF THE ALUMINUM BOTTOM RAIL

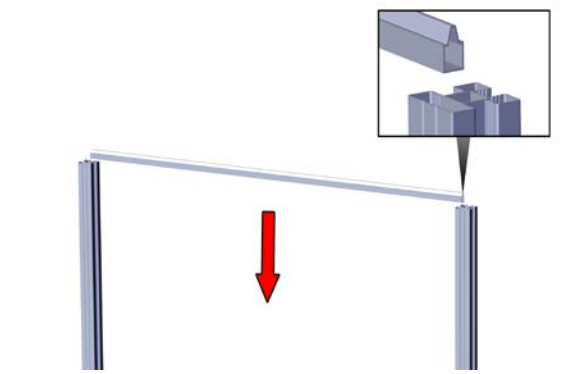

For Installation Help or Information Contact Us At:

www.ecompositeproducts.co.uk info@ecompositeproducts.co.uk [0800 599 9667](tel:08005999667)

BEGIN STEP TWO BY PLACING THE ALUMINUM BOTTOM RAIL, PART NUMBER FOUR, BETWEEN THE TWO ALUMINUM POSTS WITH THE FLAT FACE FACING DOWN. NEXT, SLIDE THE RAIL ALL THE WAY TO THE FLOOR AND MAKE SURE IT LAYS FLAT ON THE GROUND.

STEP 3: INSTALLING THE NINE WPC PANELS

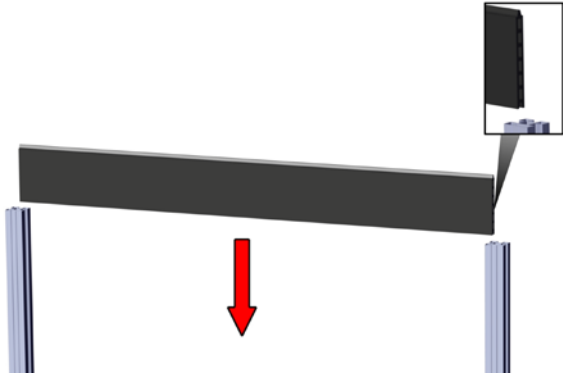

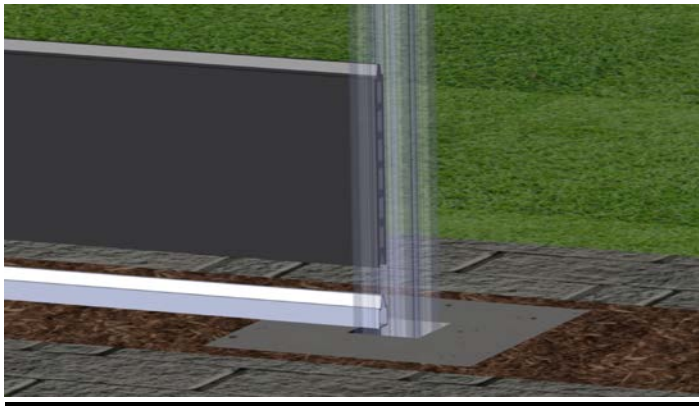

PLACE ONE WPC PANEL BETWEEN THE TWO ALUMINUM POSTS. THE NOTCHED SECTION OF THE PANEL GOES FACE DOWN WHILE THE EXTRUDED SIDE GOES FACE UP.



NEXT, SLIDE THE PANEL ALL THE WAY TO THE BOTTOM. THE NOTCHED PART OF THE PANEL MUST SLIDE INTO THE BOTTOM ALUMINUM RAIL AND LOCK INTO PLACE.

For Installation Help or Information Contact Us At:

 www.ecompositeproducts.co.uk  info@ecompositeproducts.co.uk  0800 599 9667

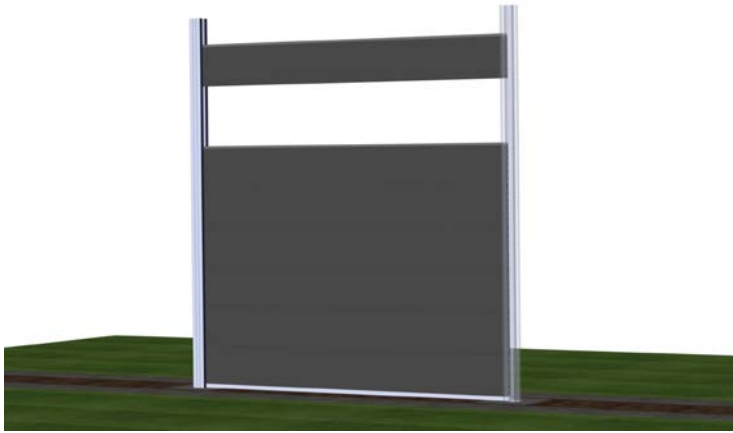

PROCEED BY ADDING THE REMAINDER OF THE PANELS WITH EACH ONE SLIDING DOWN AND LOCKING INTO PLACE.

STEP 4: ALUMINUM TOP RAIL INSTALLATION



BEGIN STEP FOUR BY PLACING THE ALUMINUM TOP RAIL, PART NUMBER TWO, BETWEEN BOTH ALUMINUM POSTS. PLACE THE RAIL WITH THE NOTCHED FACE POINTING DOWN AND THE FLAT FACE POINTING UP. SLIDE THE RAIL DOWN AND LOCK INTO PLACE ON TOP OF THE WPC PANEL.

For Installation Help or Information Contact Us At:

STEP 5: INSTALLATION OF THE ALUMINUM SPACERS

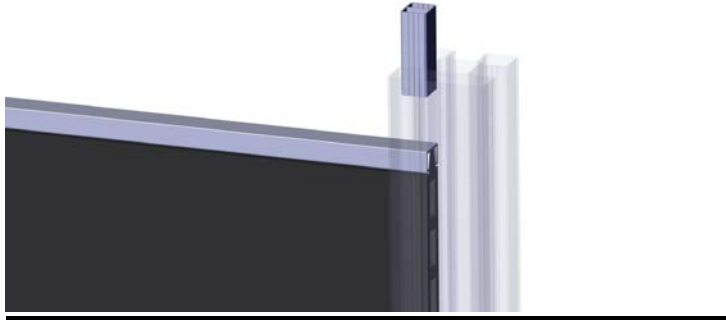

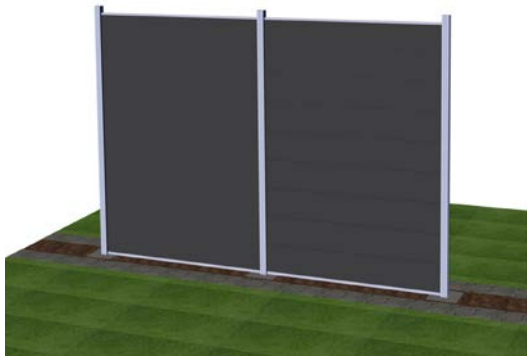

PLACE TWO ALUMINUM SPACERS ON TOP OF EACH ALUMINUM POST. SLIDE THE SPACERS IN THE INTERIOR SIDE OF EACH POST. IF THE SPACERS ARE TOO TALL, THEN TRIM THEM WITH A HACKSAW. IF THE POSTS AREN'T FIX AT EXACTLY 1900 MILLIMETER THE SPACERS MIGHT BE TOO LOW IN WHICH CASE YOU WILL NEED TO PACK UP YOUR WPC PANELS SLIGHTLY. REPEAT ON BOTH SIDES.



IF YOU ARE INSTALLING MULTIPLE FENCES THEN YOU WILL HAVE TO REPEAT THE SAME FIVE PREVIOUS STEPS FOR EACH ADDITIONAL FENCE SECTION. ADD AS MANY FENCE SECTIONS AS YOU NEED TO FIT YOUR DESIRED PARAMETER.

For Installation Help or Information Contact Us At:

 www.ecompositeproducts.co.uk  info@ecompositeproducts.co.uk  0800 599 9667

STEP 6: OPTIONAL ALUMINUM COVER STRIP INSTALLATION

STEP 6 (OPTIONAL ITEM)



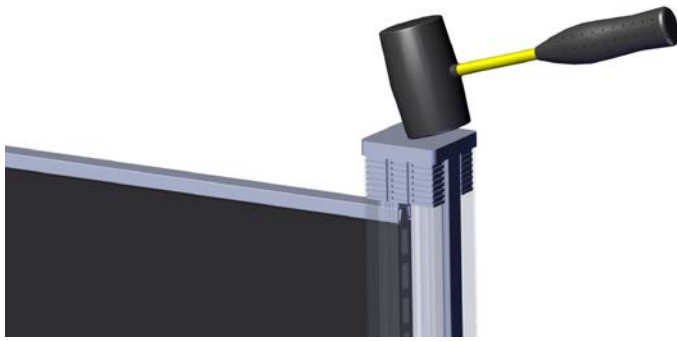

THE COVER STRIPS ARE OPTIONAL AND ARE USED TO COVER THE FENCE ENDS. SIMPLY PLACE THE COVER STRIPS AT EACH END OF THE ALUMINUM POST AND SLIDE ALL THE WAY DOWN. IF THE COVER STRIPS ARE TOO LONG AND STICK OUT YOU MIGHT HAVE TO TRIM THEM USING A HACKSAW.

STEP 7: POST CAP INSTALLATION



BEGIN BY PLACING A POST CAP ON TOP OF EACH OF THE ALUMINUM POSTS. SLIGHTLY SLIDE THE CAP INTO THE POST AND GENTLY TAP THEM INTO PLACE USING A RUBBER Mallet. REPEAT THIS FOR EACH ALUMINUM POST INSTALLED.

For Installation Help or Information Contact Us At:

 www.ecompositeproducts.co.uk  info@ecompositeproducts.co.uk  0800 599 9667